

# Automation Products

Comprising an innovative range of Universal Grippers, Rotary Actuators and Precision Slide Tables



Parker is about motion control engineering, manufacturing, application expertise and unparalleled customer service.

Parker automation products are found just about everywhere – from laboratories, cleanrooms and factory floors, to mines, foundries and satellites in space – our products are used anywhere machines, processes and people depend on reliable high-performance motion control.

Today's industrial automation applications demand the best in quality and productivity. Likewise, high-technology automation applications demand performance in quality throughput and precision.

### P5GA - Angular double acting, square jaw carriers

- Available with comprehensive range of bore sizes Ø12 - 32 mm.
- Highly accurate air driven device for holding work-piece.
- Magnetic as standard

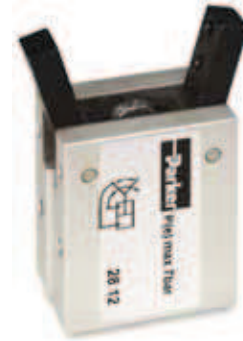

#### Sensors

Check on closing and opening of gripper by means of sensors.

#### Technical Information

Acting type	Double acting					
Bore (mm)	12	16	20	25	32	
Port size	M3 x 0.5		M5 x 0.8			
Medium	Air					
Operating pressure range	1.5 - 7 bar					
Temperature range	-5 to +60°C (no freezing)					
Max frequency	180 Cycles/min					
Lubrication	Cylinder	Lever		Not required		
				Grease		
Max. arm length mm (L)	30	40	60	70	85	
Theoretical holding force kgf-cm						
	Closed side	0.4xP	0.9xP	1.7xP	3.4xP	6.1xP
	Opened side	0.5xP	1.2xP	2.3xP	4.4xP	8.1xP
Clamp / Release angle	-10 to +30°					
Clamping force (F)	F = M / L x 0.85					
Weight (g)	53	103	193	327	525	
L : Arm length (mm), M : Theoretical moment (kgf-cm)						
F : Clamping force (kgf), P : Operating pressure (kgf/cm²)						
For more information see <a href="http://www.parker.com/euro_pneumatic">www.parker.com/euro_pneumatic</a>						

#### P5GA - Angular Grippers

Bore mm	Order code
12	<b>P5GA-012MSG030B</b>
16	<b>P5GA-016MSG030B</b>
20	<b>P5GA-020MSG030B</b>
25	<b>P5GA-025MSG030B</b>
32	<b>P5GA-032MSG030B</b>

#### Length of gripping point

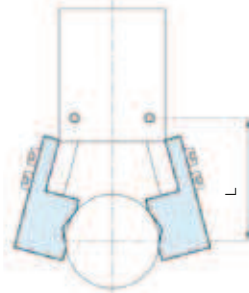

#### Installation of sensor

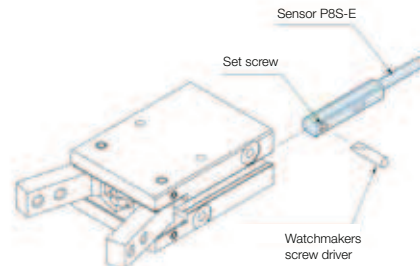

#### Sensors - Series P8S-E

Magnetic Sensor	M8 - Snap in	Flying lead
	0.165 m PUR cable with M8 connector	2 m PUR cable
PNP	<b>P8S-EPSUS</b>	<b>P8S-EPFXS</b>
NPN	<b>P8S-ENSUS</b>	<b>P8S-ENFXS</b>
Reed	<b>P8S-ERSUS</b>	<b>P8S-ERFXS</b>

**Dimensions (mm)**

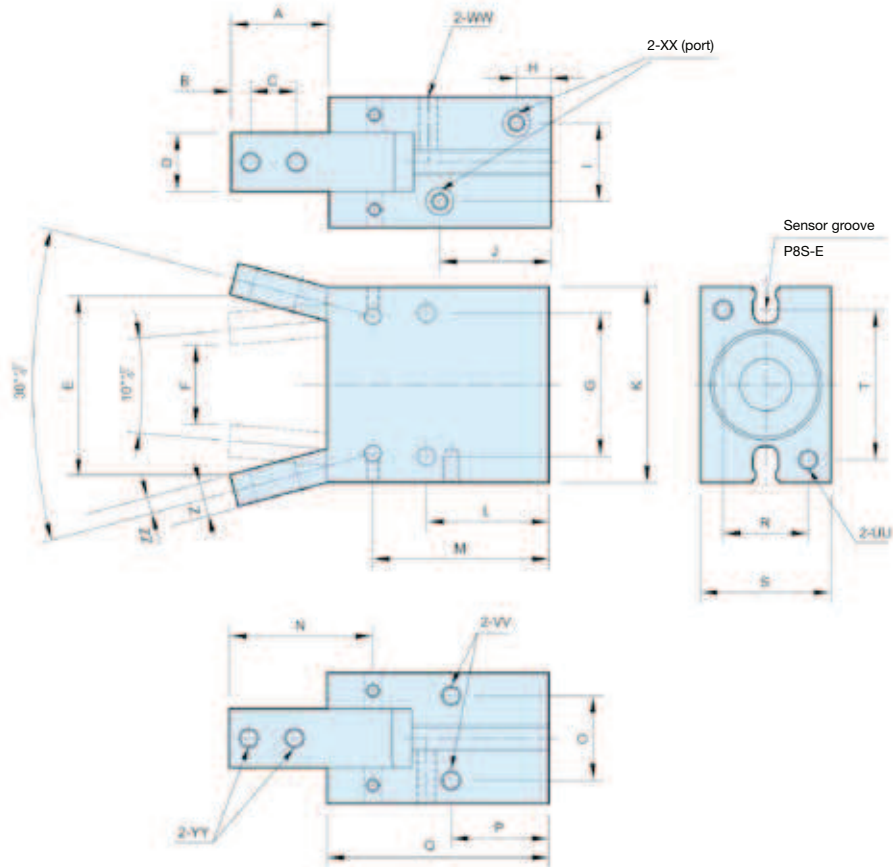

Bore mm	A	B	C	D	E	F	G	H	I	J	K	L	M	N	O	P	Q	R	S	T
12	15,4	3	6	7	26,3	9	20	7,5	10,2	23,5	28	20	32,9	21,5	10,2	16	39	10	16	22
16	17,5	3	8	9	31,1	14	24	7,5	12	22	34	22,5	35	25	14	18	42,5	14	22	26
20	22	4	10	12	40,1	18	30	8	13	25	45	25	39,5	32,5	16	19	50	16	26	35
25	26	5	12	14	47,9	21	36	8,5	18	28	52	28,5	45,5	38,5	20	21,5	58	20	32	40
32	30	6	14	18	55,1	24	44	10,5	24	34	60	37,5	54	44	26	30	68	26	40	46

Bore mm	UU	VV	WW	XX	YY	Z	ZZ
12	M3	M3	M3	M3	M3	5	2,5
16	M4	M4	M4	M5	M3	6	3
20	M5	M5	M5	M5	M4	7	3,5
25	M6	M6	M6	M5	M5	9	4
32	M6	M6	M6	M5	M6	10	5

**P5GB - Parallel double acting, square jaw carriers**

- Available with comprehensive range of bore sizes Ø12 - 32 mm.
- Highly accurate air driven device for holding work-piece.
- Magnetic as standard



**Sensors**

Check on closing and opening of gripper by means of sensors.

Technical Information						
Acting type	Double acting					
Bore (mm)	12	16	20	25	32	
Port size	M3 x 0.5		M5 x 0.8			
Medium	Air					
Operating pressure range	1.5 - 7 bar					
Temperature range	-5 to +60°C (no freezing)					
Max frequency	180 Cycles/min					
Lubrication	Cylinder	Not required				
	Lever	Grease				
Max. arm length mm (L)	30	40	60	70	85	
Theoretical holding force kgf-cm						
	Closed side	0.8	2.4	4.7	7.5	10
	Opened side	0.5	1.8	3.5	6.0	8.5
Lever open / closed stroke	6	8	12	14	16	
Weight (g)	66	144	255	419	719	

For more information see [www.parker.com/euro\\_pneumatic](http://www.parker.com/euro_pneumatic)

**P5GB - Parallel Grippers**

Bore mm	Order code
12	<b>P5GB-012MSG006B</b>
16	<b>P5GB-016MSG008B</b>
20	<b>P5GB-020MSG012B</b>
25	<b>P5GB-025MSG014B</b>
32	<b>P5GB-032MSG016B</b>

**Length of gripping point**

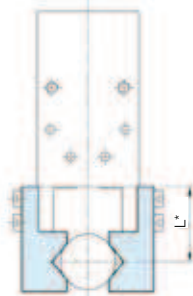

\* L = gripping joint length 30mm, pressure 5kgf/cm<sup>2</sup>

**Installation of sensor**

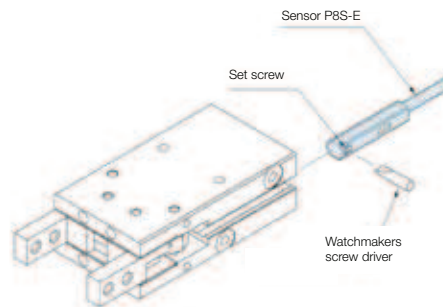

**Sensors - Series P8S-E**

Magnetic Sensor	M8 - Snap in	Flying lead
	0.165 m PUR cable with M8 connector	2 m PUR cable
PNP	<b>P8S-EPSUS</b>	<b>P8S-EPFXS</b>
NPN	<b>P8S-ENSUS</b>	<b>P8S-ENFXS</b>
Reed	<b>P8S-ERSUS</b>	<b>P8S-ERFXS</b>

**Dimensions (mm)**

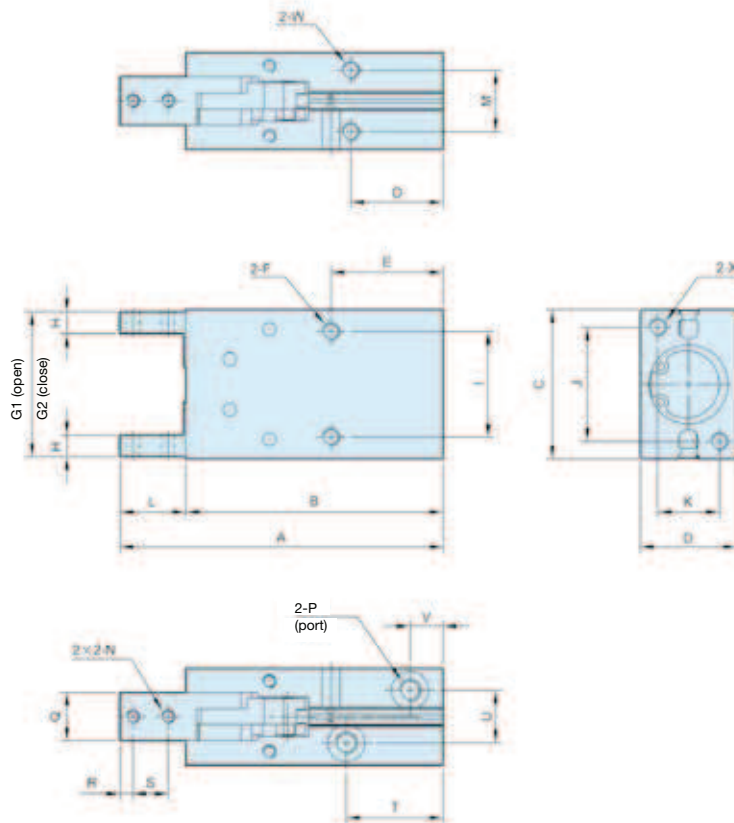

Bore mm	A	B	C	D	E	F	G1	G2	H	I	J	K	L	M	N	O	P
12	63,5	50,5	28	16	20	M3 x 0.5 x 5 depth	27	21	4	18	17	10	13	10	M3 x 0.5	16	M3 x 0,5 x 5 depth
16	73,5	58,5	34	22	25,5	M4 x 0.7 x 11 depth	33	25	5	24	26	14	15	14	M3 x 0.5	21	M5 x 0,8 x 5 depth
20	88,5	69,5	45	26	25	M5 x 0.8 x 8 depth	44	32	6	30	35	16	19	16	M4 x 0.7	19	M5 x 0,8 x 5 depth
25	102,5	78,5	52	32	28	M6 x 1.0 x 10 depth	51	37	8	36	40	20	24	20	M5 x 0.8	22	M5 x 0,8 x 5 depth
32	120,5	90,5	60	40	34	M6 x 1.0 x 10 depth	59	43	10	44	46	24	30	26	M6 x 1.0	26	M5 x 0,8 x 5 depth

Bore mm	Q	R	S	T	U	V	W	X
12	7	3	6	23	10,2	7,5	M3 x 0.5 x 5 depth	M3 x 0.5 x 5 depth
16	11	3	8	22	12	7,5	M4 x 0.7 x 7 depth	M4 x 0.7 x 7 depth
20	12	4	10	26	13	8	M5 x 0.8 x 8 depth	M5 x 0.8 x 8 depth
25	14	5	12	29	18	8,5	M6 x 1.0 x 10 depth	M6 x 1.0 x 10 depth
32	20	7	15	35	24	10,5	M6 x 1.0 x 10 depth	M6 x 1.0 x 10 depth

**P5GD - Parallel precision guided double acting, square jaw carriers**

- Integral linear guide used for high rigidity and high precision.
- Stainless steel jaw carriers.
- Magnetic as standard.



**Sensors**

Check on closing and opening of gripper by means of sensors.

**Technical Information**

Acting type	Double acting		
Bore (mm)	10	16	20   25
Port size	M3 x 0.5	M5 x 0.8	
Medium	Air		
Operating pressure range	2 to 7 bar		1 to 7 bar
Temperature range	-10 to +60°C (no freezing)		
Repeatability	± 0.01 mm		
Max operating frequency	180 Cycles/min		
Lubrication	Not required		
Weight (g)	55	125	250   460

**P5GD - Parallel Grippers**

Bore mm	Order code
10	<b>P5GD-010MSG004B</b>
16	<b>P5GD-016MSG006B</b>
20	<b>P5GD-020MSG010B</b>
25	<b>P5GD-025MSG014B</b>

Bore	Gripping force <sup>(1)</sup>		Opening closing stroke (both sides) (mm)
	Gripping force per finger effective value N (kgf)		
	External	Internal	
10	9.8 (1)	17 (1.7)	4
16	30 (3.1)	40 (4.1)	6
20	42 (4.3)	66 (6.7)	10
25	65 (6.6)	104 (10.6)	14

<sup>1)</sup> Values based on pressure of 0.5 MPa (5.1 kgf/cm<sup>2</sup>)  
For more information see [www.parker.com/euro\\_pneumatic](http://www.parker.com/euro_pneumatic)

**Length of gripping point**

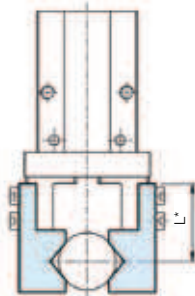

\* L = Gripping point L = 20mm at center of stroke

**Installation of sensor**

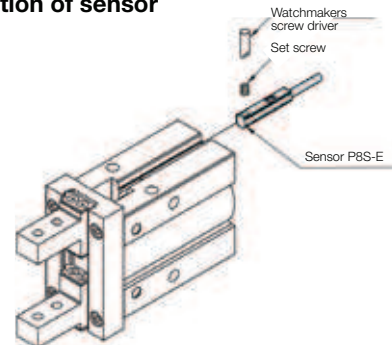

**Sensors - Series P8S-E**

Magnetic Sensor	M8 - Snap in	Flying lead
	0.165 m PUR cable with M8 connector	2 m PUR cable
PNP	<b>P8S-EPSUS</b>	<b>P8S-EPFXS</b>
NPN	<b>P8S-ENSUS</b>	<b>P8S-ENFXS</b>
Reed	<b>P8S-ERSUS</b>	<b>P8S-ERFXS</b>

**Dimensions (mm)**

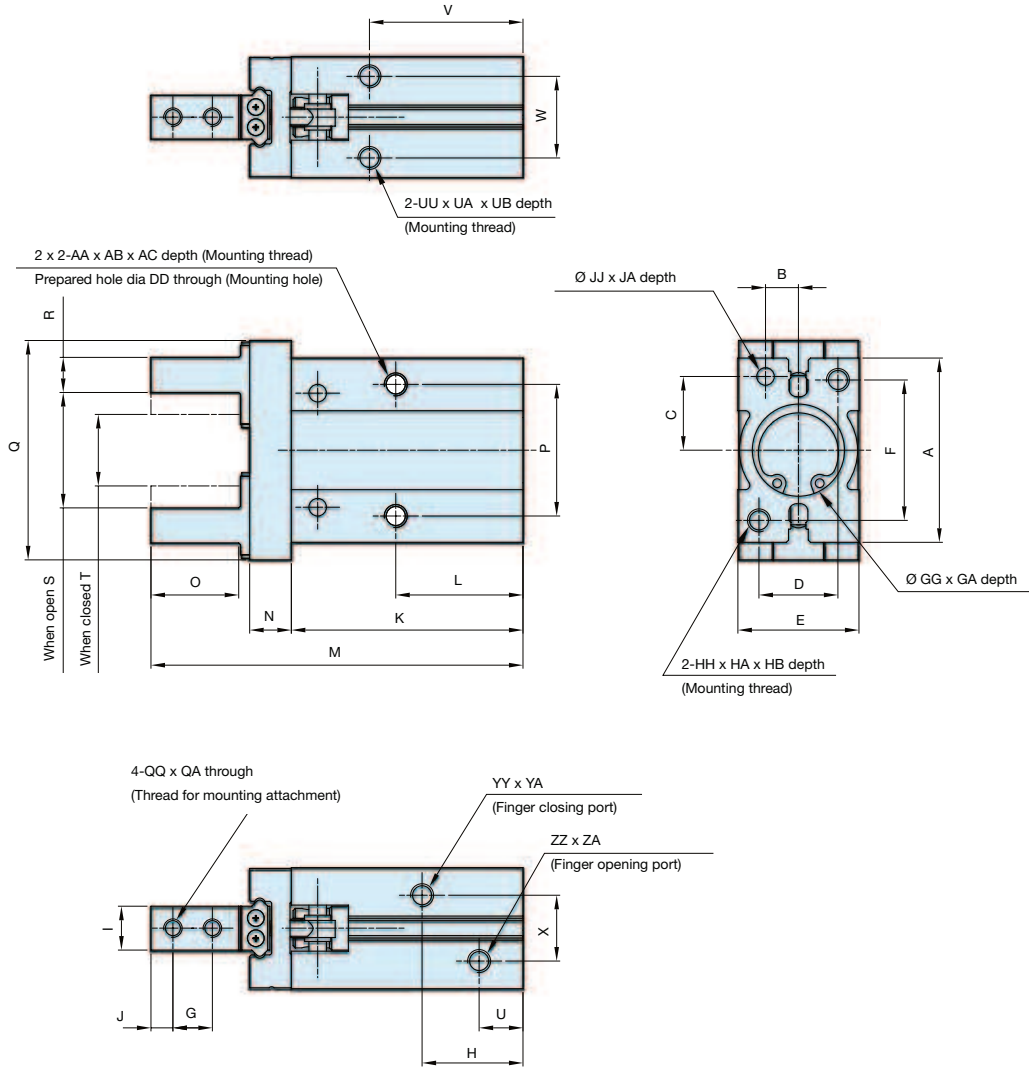

Bore mm	A	AA	AB	AC	B	C	D	DD	E	F	G	GG	GA	H	HH	HA	HB	I	J	JJ	JA	K	L	M
10	23	M3	0.5	5.5	5.2 <sup>+0.025</sup> <sub>0</sub>	7.6 <sup>+0.02</sup> <sub>-0.02</sub>	12	2.6	16.4 <sup>+0.05</sup> <sub>-0.05</sub>	18	5.7	11H9 <sup>+0.043</sup> <sub>-0</sub>	2	19	M3	0.5	6	5 <sup>0</sup> <sub>-0.05</sub>	3	2H9 <sup>+0.025</sup> <sub>-0</sub>	3	37.8	23	57
16	30.6	M4	0.7	8	6.5 <sup>+0.25</sup> <sub>0</sub>	11 <sup>+0.02</sup> <sub>-0.02</sub>	15	3.4	23.6 <sup>+0.05</sup> <sub>-0.05</sub>	22	7	17H9 <sup>+0.043</sup> <sub>-0</sub>	2	19	M4	0.7	8	8 <sup>0</sup> <sub>-0.05</sub>	4	3H9 <sup>+0.025</sup> <sub>-0</sub>	3	42.5	24.5	67.3
20	42	M5	0.8	10	7.5 <sup>+0.030</sup> <sub>0</sub>	16.8 <sup>+0.02</sup> <sub>-0.02</sub>	18	3.4	27.6 <sup>+0.05</sup> <sub>-0.05</sub>	32	9	21H9 <sup>+0.052</sup> <sub>-0</sub>	3	23	M5	0.8	10	10 <sup>0</sup> <sub>-0.05</sub>	5	4H9 <sup>+0.030</sup> <sub>-0</sub>	4	52.8	29	84.8
25	52	M6	1	12	10 <sup>+0.02</sup> <sub>-0.02</sub>	21.8 <sup>+0.02</sup> <sub>-0.02</sub>	22	5.1	33.6 <sup>+0.05</sup> <sub>-0.05</sub>	40	12	21H9 <sup>+0.052</sup> <sub>-0</sub>	3.5	23.5	M6	1	12	12 <sup>0</sup> <sub>-0.05</sub>	6	4H9 <sup>+0.02</sup> <sub>-0.02</sub>	4	63.6	30	102.7
Bore mm	N	O	P	Q	QQ	QA	R	S	T	U	UU	UA	UB	V	W	X	YY	YA	ZZ	ZA				
10	6	12	16	29	M2.5	0.45	4 <sup>0</sup> <sub>-0.1</sub>	15.2 <sup>+2.2</sup> <sub>0</sub>	11.2 <sup>0</sup> <sub>-0.7</sub>	9	M3	0.5	6	27	11.4	10	M3	0.5	M3	0.5				
16	7.5	15	24	38	M3	0.5	5 <sup>0</sup> <sub>-0.1</sub>	20.9 <sup>+2.2</sup> <sub>-0.2</sub>	14.9 <sup>0</sup> <sub>-0.7</sub>	8.5	M4	0.7	4.5	30	16	13	M5	0.8	M5	0.8				
20	9.5	20	30	50	M4	0.7	8 <sup>0</sup> <sub>-0.1</sub>	26.3 <sup>+2.2</sup> <sub>-0.2</sub>	16.3 <sup>0</sup> <sub>-0.7</sub>	10	M5	0.8	8	35	18.6	15	M5	0.8	M5	0.8				
25	11	25	36	63	M5	0.8	10 <sup>0</sup> <sub>-0.1</sub>	33.3 <sup>+2.2</sup> <sub>-0.2</sub>	19.3 <sup>0</sup> <sub>-0.8</sub>	9.7	M6	1	10	36.5	22	20	M5	0.8	M5	0.8				



### P5GL - 180° Angular double acting, cam style, square jaw carriers

- Compact design and lightweight construction.
- High gripping forces achieved via internal cams.
- Reference points on gripping fingers are standard.
- Sensors can be mounted in any one of four positions.
- Dust seals protect all internal parts from ingress of dirt.



#### Sensors

Check on closing and opening of gripper by means of sensors.

#### P5GL - 180° Angular Grippers - Cam Style



Bore mm	Order code
10	<b>P5GL-010MSG180B</b>
16	<b>P5GL-016MSG180B</b>
20	<b>P5GL-020MSG180B</b>
25	<b>P5GL-025MSG180B</b>

#### Technical Information

Acting type	Double acting			
Bore (mm)	10	16	20	25
Medium	Air			
Operating pressure range	1 to 6 bar			
Temperature range	-10 to +60°C (no freezing)			
Repeatability	± 0.2 mm			
Max operating frequency	60 Cycles/min			
Lubrication	Not required			
Effective force (Nm) at (5kgf/cm <sup>2</sup> )	0.16	0.54	1.10	2.28
Operating angle (both sides)	Opened side	180° - 182°		
	Closed side	-3°		
Weight (g)	80	150	320	600

For more information see [www.parker.com/euro\\_pneumatic](http://www.parker.com/euro_pneumatic)

#### Sensors - Series P8S-H

Magnetic Sensor	M8 - Snap in	Flying lead
		
Reed NO	0.165 m PUR cable with M8 connector <b>P8S-HRSUS</b>	1 m PUR cable <b>P8S-HRFCS</b>



**Dimensions (mm)**

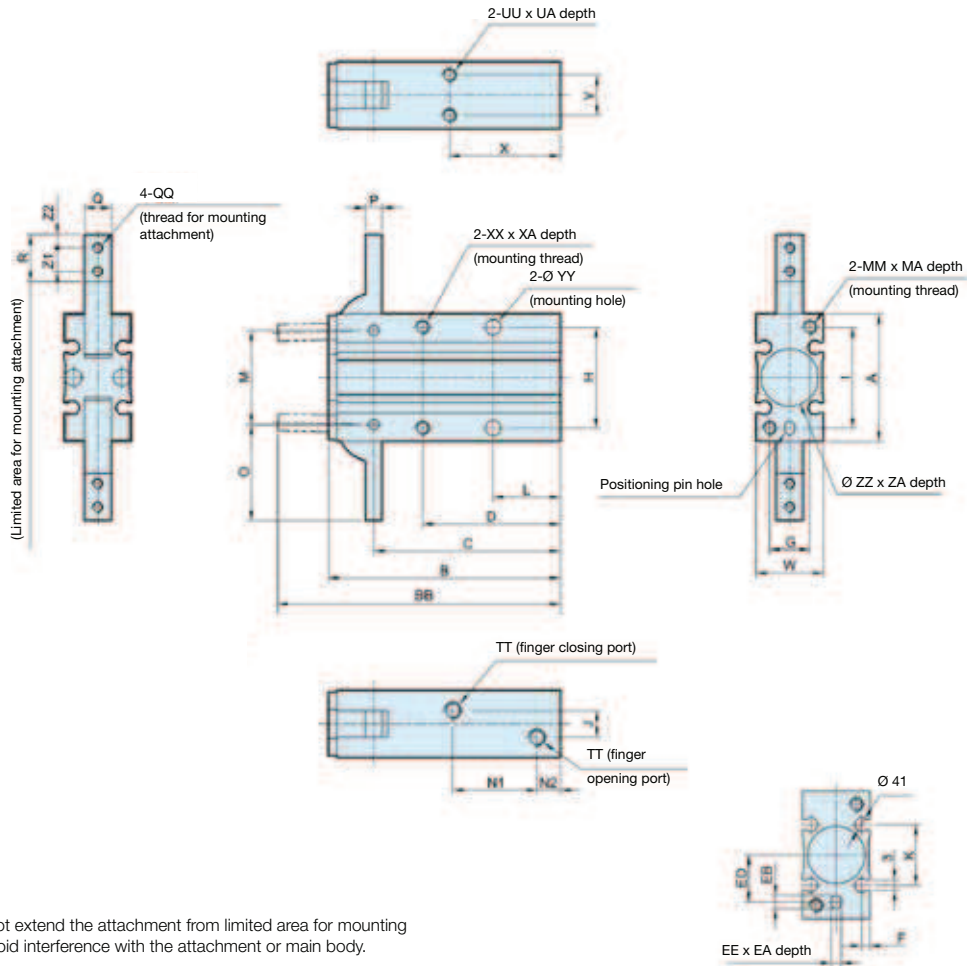

\* Do not extend the attachment from limited area for mounting to avoid interference with the attachment or main body.

Bore mm	A	B	BB	C	D	EE	EA	EB	ED	F	G	H	I	J	K	L	M	MA	MM	N1	N2	O	P	Q	
12	30	58	71	47,5	35	3H9 <sup>+0,025</sup> <sub>0</sub>	3	4	9	2	9	24	24	3	13	18	22	6	M3 x 0.5	23	7	23,5	4	6	<sup>+0,005</sup> <sub>-0,025</sub>
16	38	69	84	55,5	41	3H9 <sup>+0,025</sup> <sub>0</sub>	3	4	15	2,5	12	30	30	8	18	20	28	8	M4 x 0.7	25	7	28,5	5	8	<sup>+0,005</sup> <sub>-0,025</sub>
20	48	86	106	69	50	4H9 <sup>+0,030</sup> <sub>0</sub>	4	5	19	3	16	36	38	12	20	25	36	10	M5 x 0.8	32	8	37	8	10	<sup>+0,005</sup> <sub>-0,025</sub>
25	58	107	131	86	60	4H9 <sup>+0,030</sup> <sub>0</sub>	4	5	23	3	18	42	46	14	24	30	45	12	M6 x 1	42	8	45	10	12	<sup>+0,005</sup> <sub>-0,025</sub>

Bore mm	QH	QQ	R	TT	UA	UU	W	X	XA	XX	Y	YY	ZA	ZZ	Z1	Z2
12	3,4	M3 x 0.5	12	M5 x 0.8	4	M3 x 0.5	15	30	6	M3 x 0.5	9	3,4	1,5	11H9 <sup>+0,043</sup> <sub>0</sub>	6	3
16	3,4	M3 x 0.5	14	M5 x 0.8	5	M4 x 0.7	20	33	8	M4 x 0.7	12	4,5	1,5	17H9 <sup>+0,043</sup> <sub>0</sub>	7	4
20	4,5	M4 x 0.7	18	M5 x 0.8	8	M5 x 0.8	26	42	10	M5 x 0.8	14	5,5	1,5	21H9 <sup>+0,052</sup> <sub>0</sub>	9	5
25	5,5	M5 x 0.8	22,5	M5 x 0.8	10	M6 x 1	30	50	12	M6 x 1	16	6,6	1,5	26H9 <sup>+0,052</sup> <sub>0</sub>	12	6

## P5RS - Rotary Actuators

The P5RS rotary table units provide precise control even under heavy loads, with specially designed load fixing and centring capabilities. End stroke cushioning using supplied adjusting bolts or optional shock absorbers offers dependable linear cushioning enabling objects to be carried and positioned safely and securely.



- Bores Ø16, 20, 25 and 32 mm
- Twin rack and pinion
- Adjustable between 0° and 190°
- Magnetic piston standard
- Stroke adjusters standard
- Available with shock absorbers
- Easy mounting of work piece

### Operating Information

Pressure range:	1 to 9 bar
Temperature range:	-5° to 60° C
Filtration requirements:	
Air filtration	40 micron or better
Air lubrication	Not necessary*
Air humidity	Low moisture content (dry)

\* Addition of lubrication will greatly increase service life

For more information see [www.parker.com/euro\\_pneumatic](http://www.parker.com/euro_pneumatic)

### Ordering Information: P5RS



Bore mm	Description	Ports (BSPP)	Rotation	Torque (N-m at 7 bar)	Weight (kg)	Order code
16	Rotary table, stroke adjusters	1/8	190 degrees	1.69	0.7	<b>P5RS-016DSG190B</b>
20	Rotary table, stroke adjusters	1/8	190 degrees	3.52	1.16	<b>P5RS-020DSG190B</b>
25	Rotary table, stroke adjusters	1/8	190 degrees	6.87	1.57	<b>P5RS-025DSG190B</b>
32	Rotary table, stroke adjusters	1/8	190 degrees	13.52	3.07	<b>P5RS-032DSG190B</b>

**Note:** Above units are supplied with rubber buffer stroke adjusters.

### Optional Shock Absorbers

Bore mm	Rotary Actuator	Order code
16	P5RS-016DSG190B	<b>MC25M-NB</b>
20	P5RS-020DSG190B	<b>MC75M-NB</b>
25	P5RS-025DSG190B	<b>MC150M</b>
32	P5RS-032DSG190B	<b>MC225M</b>

### Sensors - Series P8S-F

Magnetic Sensor	M8 - Snap in	Flying lead
		
Reed, NO	0.15 m PUR cable with M8 connector <b>P8S-FRSUS</b>	2 m PUR cable <b>P8S-FRFXS</b>

**Load capacity P5RS Rotary Table**

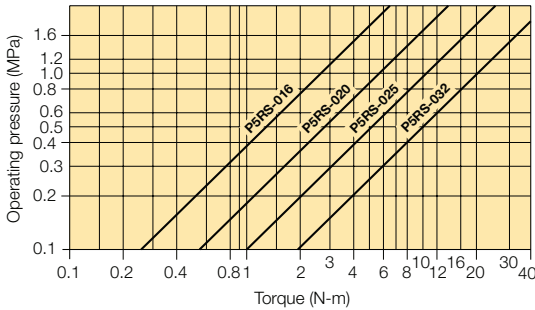

**Allowable load**

Set the load and moment to be applied to the table within the allowable values shown in the table below. (Values outside of limitations will cause excessive play, deteriorate accuracy, and shorten service life).

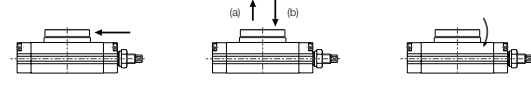

Bore	Allowable radial load (N)	Allowable thrust load (N)		Allowable moment (Nm)
		(a)	(b)	
16	78	74	78	2.4
20	147	137	137	4.0
25	196	197	363	5.3
32	314	296	451	9.7

**Dimensions P5RS Rotary Table**

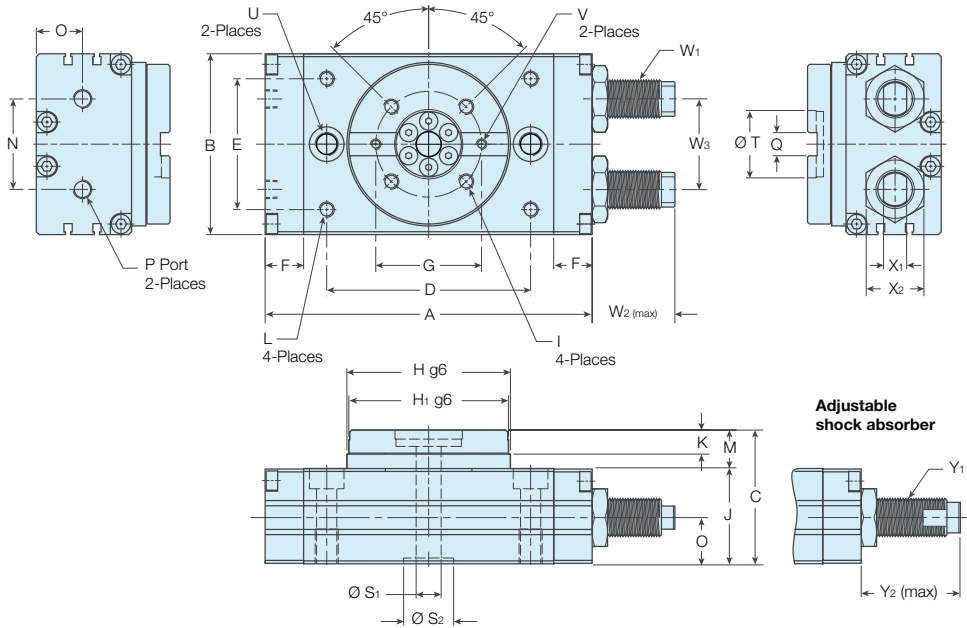

Bore mm	A	B	C	D	E	F	G	H	H <sub>1</sub>	I	J	K	L	M	N	O	P BSPP		Q
16	108	58	47	62	38	15	38	50	48	M5 x 7 Dp, P.C.D38	33	8	M5 x 8 Dp	14	26	15.5	PT 1/8	8	$8^{+0.03} \times 3.3$ Dp
20	128	68	55	78	47	15	46	62.5	60	M6 x 7 Dp, P.C.D46	38	10	M6 x 8 Dp	17	27	18.5	PT 1/8	10	$10^{+0.03} \times 3.5$ Dp
25	135.5	77	58.5	84	55	15.5	48	67	65	M6 x 9 Dp, P.C.D48	41.5	10	M6 x 8 Dp	17	37	20	PT 1/8	12	$12^{+0.03} \times 4$ Dp
32	170	94	69.5	106	68	20	55	85	83	M8 x 10 Dp, P.C.D55	49.5	12.5	M8 x 8.5 Dp	20	47	24	PT 1/8	12	$12^{+0.03} \times 5$ Dp

Bore mm	S <sub>1</sub>	S <sub>2</sub>	T	U		V	W <sub>1</sub>	W <sub>2</sub>	W <sub>3</sub>	X <sub>1</sub>	X <sub>2</sub>	Y <sub>1</sub>	Y <sub>2</sub>
16	6	17 (H7) x 2.5 Dp	24 (H7) x 3 Dp	2-Ø 6.8 thru, Ø11 x 6.5 Dp,	M8 x 12 Dp (Sink)	M3 x 4 Dp	M10 x 1,0	27	26	7	17	MC25M-NB	27
20	10	22 (H7) x 2.5 Dp	32 (H7) x 3 Dp	2-Ø 8.6 thru, Ø14 x 8.5 Dp,	M10 x 15 Dp (Sink)	M4 x 6 Dp	M12 x 1,0	23	32	8	19	MC75M-NB	38
25	13	22 (H7) x 3 Dp	32 (H7) x 3.7 Dp	2-Ø 8.6 thru, Ø14 x 8.5 Dp,	M10 x 15 Dp (Sink)	M4 x 5 Dp	M14 x 1,5	36	37	8	22	MC150M	52
32	13	26 (H7) x 3 Dp	35 (H7) x 4.7 Dp	2-Ø 10.5 thru, Ø18 x 10.5 Dp,	M12 x 18 Dp (Sink)	M5 x 5 Dp	M20 x 1,5	43	47	12	30	MC225M	62

Dimensions in (mm)



## P5SS - Precision Slide Tables

The Precision Slide Table P5SS is a pneumatic actuator, operated by two cylinders mounted in parallel for moving loads fitted on its mobile carriage or on its front plate quickly and accurately. Optional end of stroke adjusters offer precise adjustment even when the slide table is pressurised.



- High precision
- Bores Ø6, 8, 12, 16, 20 and 25mm
- Combination of dual bore cylinder and linear rail
- Magnetic piston standard
- Rubber bumper standard
- Optional stroke adjusters available
- Optional shock absorbers available

### Operating Information

Pressure range: 1.5 to 7 bar

Temperature range: -5° to 60° C

Filtration requirements:

Air filtration 40 micron or better

Air lubrication Not necessary\*

Air humidity Low moisture content (dry)

\* Addition of lubrication will greatly increase service life

For more information see [www.parker.com/euro\\_pneumatic](http://www.parker.com/euro_pneumatic)

### Ordering Information: P5SS

#### Ø6mm bore

Stroke (mm)	Order code
10	P5SS-006DSG010B
20	P5SS-006DSG020B
30	P5SS-006DSG030B
40	P5SS-006DSG040B
50	P5SS-006DSG050B

#### Ø12mm bore

Stroke (mm)	Order code
10	P5SS-012DSG010B
20	P5SS-012DSG020B
30	P5SS-012DSG030B
40	P5SS-012DSG040B
50	P5SS-012DSG050B
75	P5SS-012DSG075B
100	P5SS-012DSG100B

#### Ø20mm bore

Stroke (mm)	Order code
10	P5SS-020DSG010B
20	P5SS-020DSG020B
30	P5SS-020DSG030B
40	P5SS-020DSG040B
50	P5SS-020DSG050B
75	P5SS-020DSG075B
100	P5SS-020DSG100B
125	P5SS-020DSG125B

#### Ø8mm bore

Stroke (mm)	Order code
10	P5SS-008DSG010B
20	P5SS-008DSG020B
30	P5SS-008DSG030B
40	P5SS-008DSG040B
50	P5SS-008DSG050B
75	P5SS-008DSG075B

#### Ø16mm bore

Stroke (mm)	Order code
10	P5SS-016DSG010B
20	P5SS-016DSG020B
30	P5SS-016DSG030B
40	P5SS-016DSG040B
50	P5SS-016DSG050B
75	P5SS-016DSG075B
100	P5SS-016DSG100B
125	P5SS-016DSG125B

#### Ø25mm bore

Stroke (mm)	Order code
10	P5SS-025DSG010B
20	P5SS-025DSG020B
30	P5SS-025DSG030B
40	P5SS-025DSG040B
50	P5SS-025DSG050B
75	P5SS-025DSG075B
100	P5SS-025DSG100B
125	P5SS-025DSG125B
150	P5SS-025DSG150B

### Sensors - Series P8S-E

#### Magnetic Sensor



PNP

NPN

Reed

#### M8 - Snap in



0.165 m PUR cable with M8 connector

**P8S-EPSUS**

**P8S-ENSUS**

**P8S-ERSUS**

#### Flying lead



2 m PUR cable

**P8S-EPFXS**

**P8S-ENFXS**

**P8S-ERFXS**

**Precision Slide Table Ø6 - Dimensions (mm)**

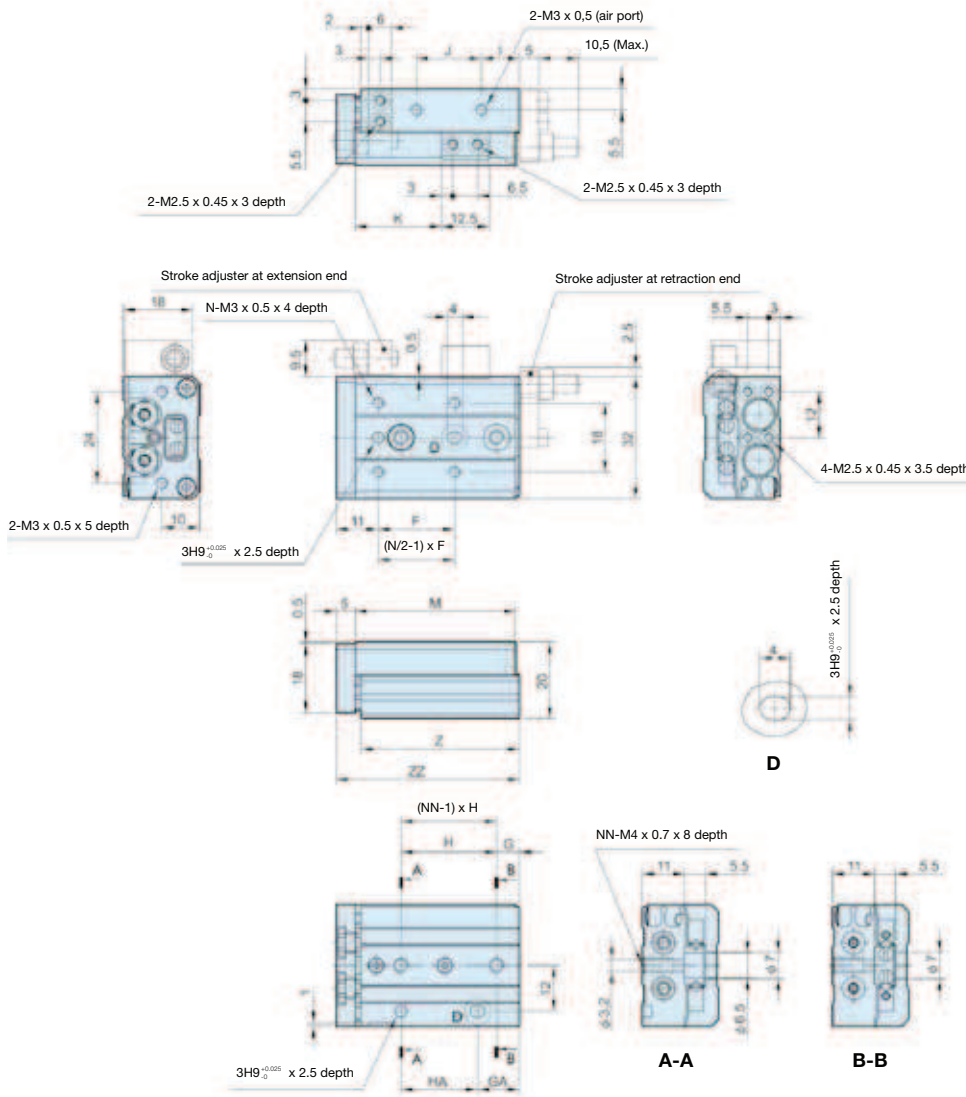

Stroke	F	G	GA	H	HA	I	J	K	M	N	NN	Z	ZZ
10	20	6	11	25	20	10	17	22,5	42	4	2	41,5	48
20	30	6	21	35	20	10	27	32,5	52	4	2	51,5	58
30	20	11	31	20	20	7	40	42,5	62	6	3	61,5	68
40	28	13	43	30	30	19	50	52,5	84	6	3	83,5	90
50	38	17	41	24	48	25	60	62,5	100	6	4	99,5	106

Precision Slide Table Ø8 - Dimensions (mm)

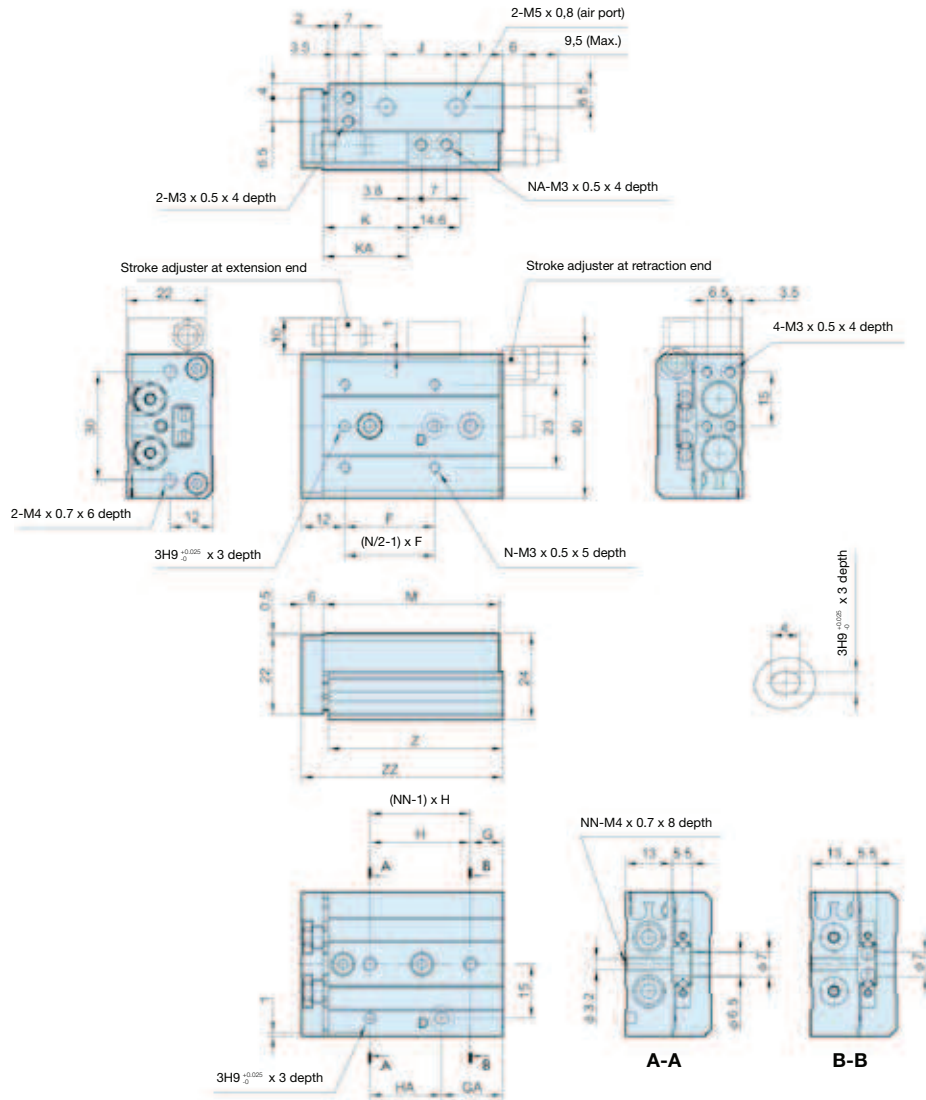

Stroke	F	G	GA	H	HA	I	J	K	KA	M	N	NA	NN	Z	ZZ
10	25	9	17	28	20	13	19,5	23,5	-	49	4	2	2	48,5	56
20	25	12	12	30	30	8,5	29	33,5	-	54	4	2	2	53,5	61
30	40	13	33	20	20	9,5	39	43,5	-	65	4	2	3	64,5	72
40	50	15	43	28	28	10,5	56	53,5	-	83	4	2	3	82,5	90
50	38	20	43	23	46	24,5	60	63,5	82,5	101	6	4	4	100,5	108
75	50	27	83	28	56	38,5	96	88,5	132,5	151	6	4	5	105,5	158

**Precision Slide Table Ø12 - Dimensions (mm)**

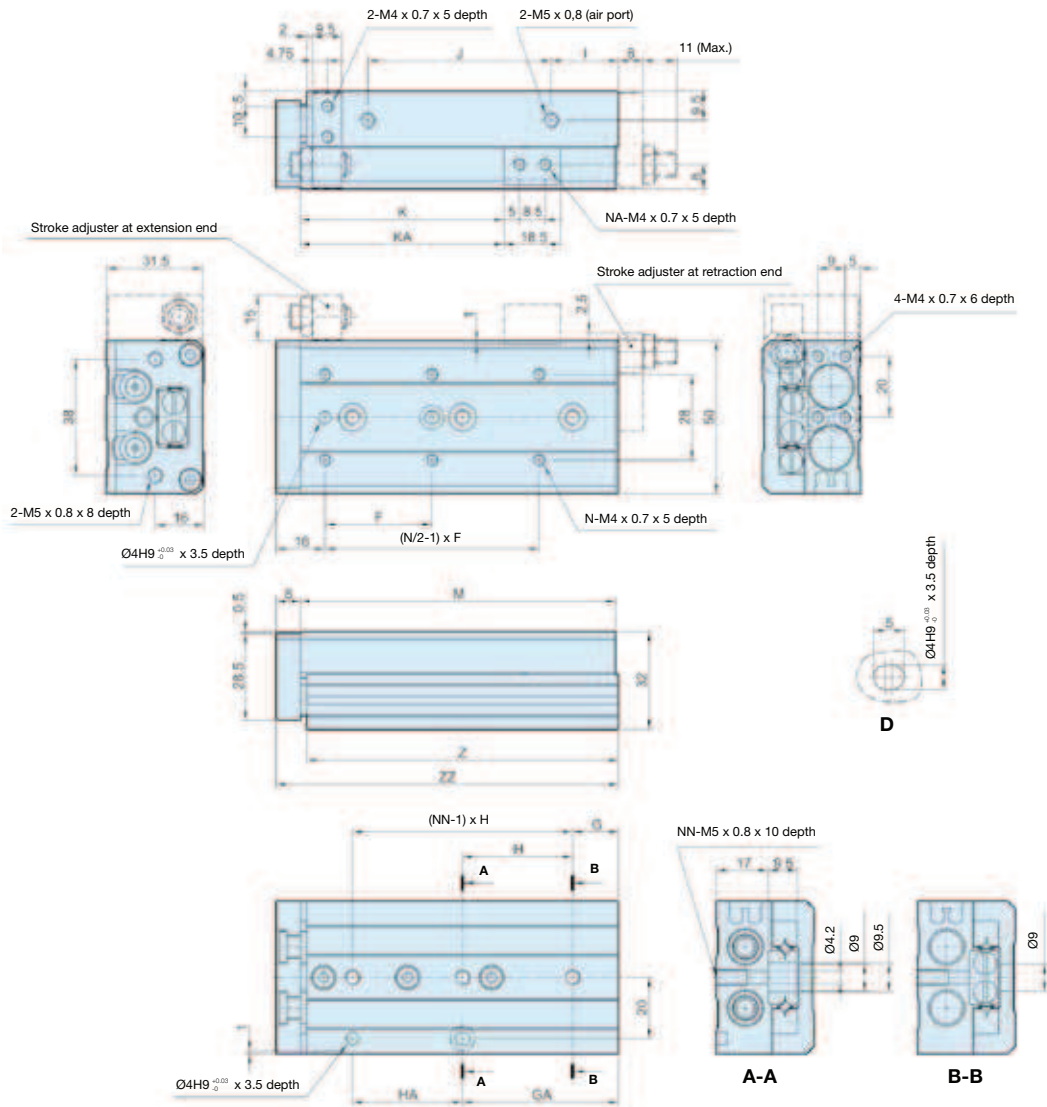

Stroke	F	G	GA	H	HA	I	J	K	KA	M	N	NA	NN	Z	ZZ
10	35	15	15	40	40	10	40	26,5	-	71	4	2	2	70	80
20	35	15	15	40	40	10	40	36,5	-	71	4	2	2	70	80
30	35	15	15	40	40	10	40	46,5	-	71	4	2	2	70	80
40	50	17	42	25	25	10	52	56,5	-	83	4	2	3	82	92
50	35	15	51	36	36	22	60	66,5	-	103	6	2	3	102	112
75	55	25	61	36	72	43	85	91,5	125,5	149	6	4	4	148	158
100	65	35	111	38	76	52	130	116,5	179,5	203	6	4	5	202	212



**Precision Slide Table Ø16 - Dimensions (mm)**

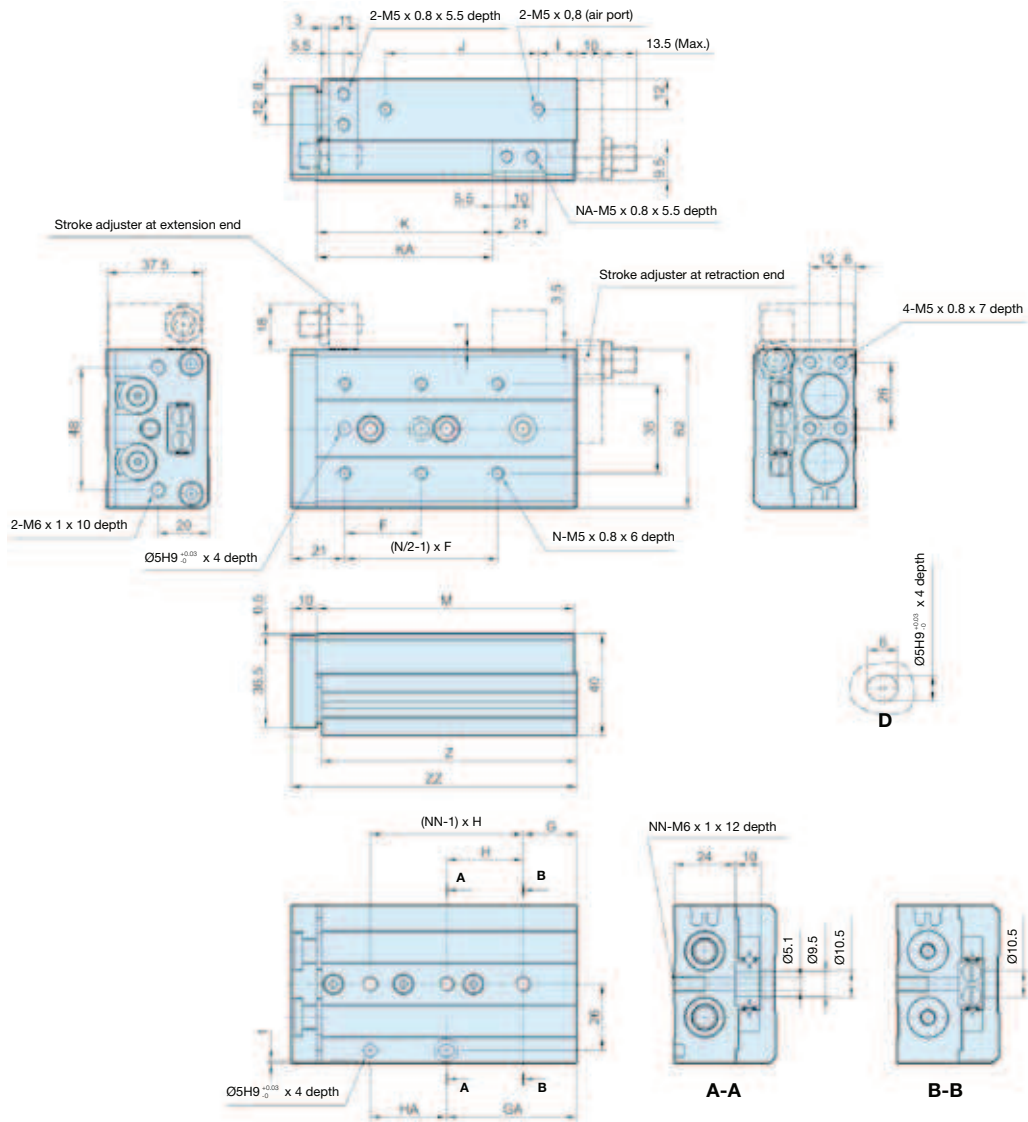

Stroke	F	G	GA	H	HA	I	J	K	KA	M	N	NA	NN	Z	ZZ
10	35	16	16	40	40	10	40	29	-	76	4	2	2	75	87
20	35	16	16	40	40	10	40	39	-	76	4	2	2	75	87
30	35	16	16	40	40	10	40	49	-	76	4	2	2	75	87
40	40	16	16	50	50	10	50	59	-	86	4	2	2	85	97
50	30	21	51	30	30	15	60	69	-	101	6	2	3	100	112
75	55	26	61	35	70	40	85	94	125	151	6	4	4	150	162
100	65	39	109	35	70	55	118	119	173	199	6	4	5	198	210
125	70	19	159	35	70	68	155	144	223	249	8	4	7	248	260

**Precision Slide Table Ø20 - Dimensions (mm)**

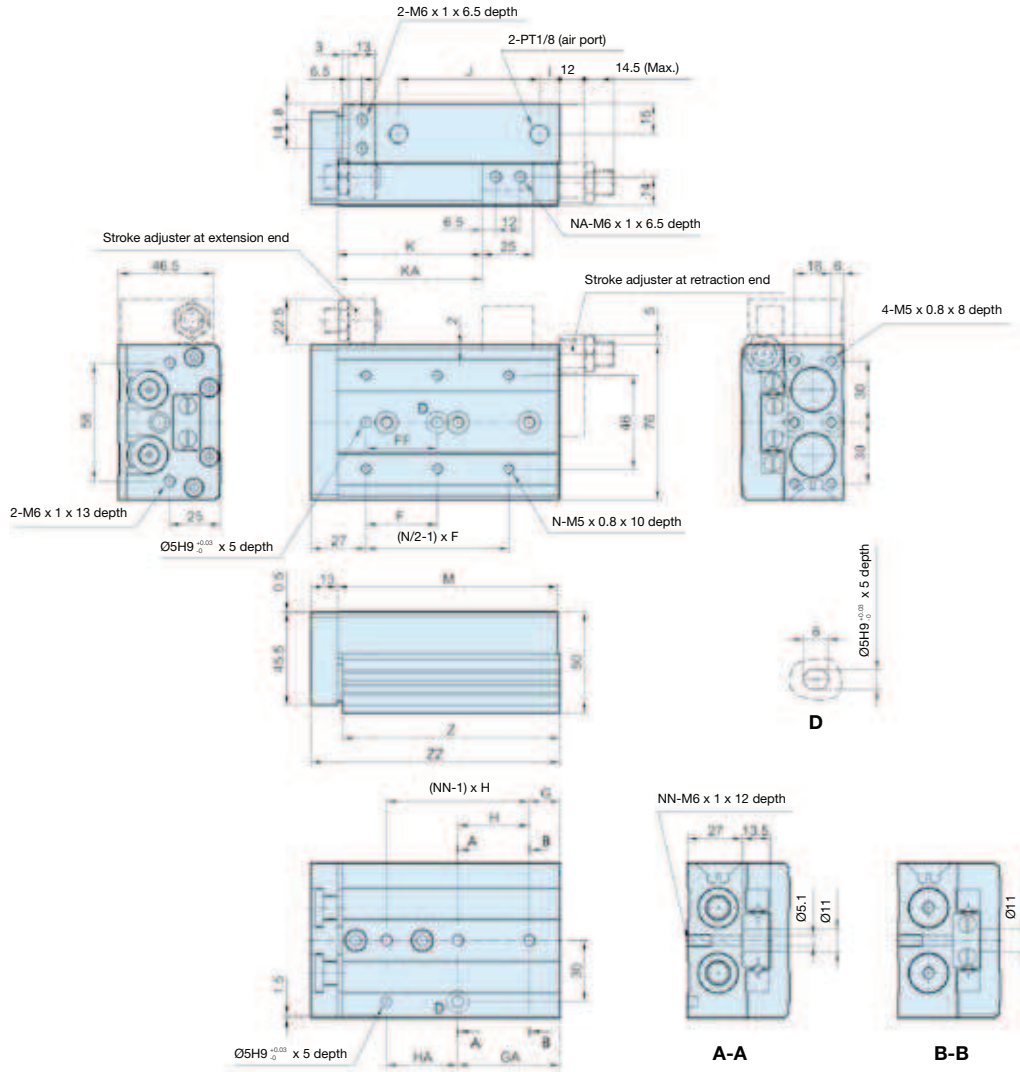

Stroke	F	FF	G	GA	H	HA	I	J	K	KA	M	N	NA	NN	Z	ZZ
10	50	40	15	25	45	35	10	44	31	-	83	4	2	2	81,5	97
20	50	40	15	25	45	35	10	44	41	-	83	4	2	2	81,5	97
30	50	40	15	25	45	35	10	44	51	-	83	4	2	2	81,5	97
40	60	50	15	35	55	35	10	54	61	-	93	4	2	2	91,5	107
50	35	35	15	50	35	35	10	69	71	-	108	6	2	3	106,5	122
75	60	60	19	54	35	70	10	108	96	-	147	6	2	4	145,5	161
100	70	70	37	107	35	70	58	113	121	169	200	6	4	5	198,5	214
125	70	70	41	155	38	76	70	155	146	223	254	8	4	6	252,5	268
150	80	80	19	195	44	88	87	190	171	275	306	8	4	7	304,5	320

Precision Slide Table Ø25 - Dimensions (mm)

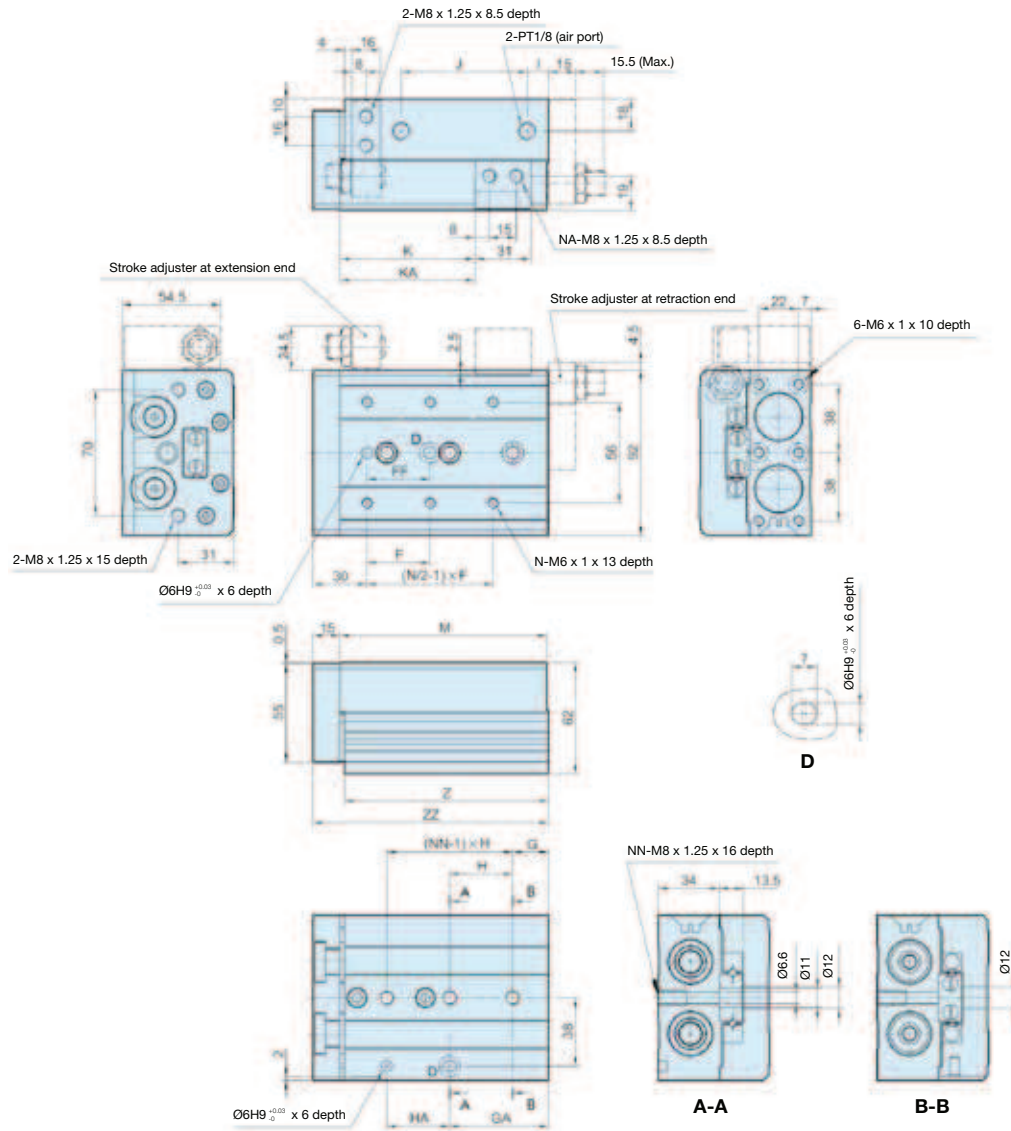

Stroke	F	FF	G	GA	H	HA	I	J	K	KA	M	N	NA	NN	Z	ZZ
10	50	40	22	22	45	45	12	47	35	-	92	4	2	2	90,5	108
20	50	40	22	22	45	45	12	47	45	-	92	4	2	2	90,5	108
30	50	40	22	22	45	45	12	47	55	-	92	4	2	2	90,5	108
40	60	50	22	22	55	55	12	57	65	-	102	4	2	2	100,5	118
50	35	35	20	55	35	35	12	70	75	-	115	6	2	3	113,5	131
75	60	60	26	61	35	70	33	90	100	-	156	6	2	4	154,5	172
100	70	70	32	102	35	70	50	114	125	162	197	6	4	5	195,5	213
125	75	75	40	154	38	76	67	155	150	218	255	8	4	6	253,5	271
150	80	80	30	190	40	80	82	180	175	258	295	8	4	7	293,5	311

**Accessories Ø6 - Ø25**

**Stroke adjuster at extension end:**

Mounted to body

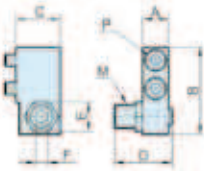

Mounted to table



Bore mm	Order code	Adjustable stroke range (mm)	Mounted to body							Mounted to table					
			A	B	C	D	E	F	M	P*	H	I	J	Q*	
6	P5SS-006-EA-05	5	6	17,8	10,5	16,5		7	2,5	M5 x 0.8	M2.5x10	12,5	6	8,5	M2.5 x 8
	P5SS-006-EA-15	15				26,5									
8	P5SS-008-EA-05	5	7	21,5	11	16,5		8	3	M6 x 1	M3 x 10	14,6	7	10	M3 x 10
	P5SS-008-EA-15	15				26,5									
	P5SS-008-EA-25	25				36,5									
	P5SS-012-EA-05	5				20									
12	P5SS-012-EA-15	15	9,5	31	16	30		11	4	M8 x 1	M4 x 16	18,5	10	13	M4 x 12
	P5SS-012-EA-25	25				40									
16	P5SS-016-EA-05	5	11	37	19	24,5		14	5	M10 x 1	M5 x 16	21	12	16,5	M5 x 16
	P5SS-016-EA-15	15				34,5									
	P5SS-016-EA-25	25				44,5									
	P5SS-020-EA-05	5				27,5									
20	P5SS-020-EA-15	15	13	45,5	24	37,5		17	6	M12 x 1.25	M6 x 20	25	13	21	M6 x 20
	P5SS-020-EA-25	25				47,5									
	P5SS-025-EA-05	5				32,5									
	P5SS-025-EA-15	15				16	53,5								
P5SS-025-EA-25	25	52,5													

\* Size of hexagon socket head cap screws

**Stroke adjuster at retraction end:**

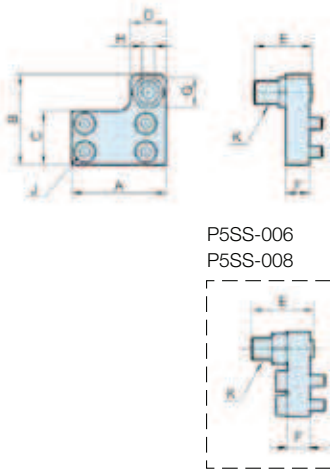

Bore mm	Order code	Adjustable stroke range (mm)	A	B	C	D	E	F	G	H	J*	K	
			6	P5SS-006-RA-05	5	21	19	10,5	8	16,5		5	7
P5SS-006-RA-15	15	26,5											
8	P5SS-008-RA-05	5	25	22,5	12,5	9	16,5		6	8	3	M3 x 10	M6 x 1
	P5SS-008-RA-15	15					26,5						
	P5SS-008-RA-25	25					36,5						
	P5SS-012-RA-05	5					20						
12	P5SS-012-RA-15	15	32	31	18,5	13	30		8	12	4	M4 x 8	M8 x 1
	P5SS-012-RA-25	25					40						
16	P5SS-016-RA-05	5	40	38,5	23	15	24,5		10	14	5	M5 x 10	M10 x 1
	P5SS-016-RA-15	15					34,5						
	P5SS-016-RA-25	25					44,5						
	P5SS-020-RA-05	5					27,5						
20	P5SS-020-RA-15	15	50	48	29	21	37,5		12	17	6	M5 x 12	M12 x 1.25
	P5SS-020-RA-25	25					47,5						
	P5SS-025-RA-05	5					32,5						
	P5SS-025-RA-15	15					60	58					
P5SS-025-RA-25	25	52,5											

\* Size of hexagon socket head cap screws

**Accessories Ø8 - Ø25**

**Shock absorber at extension end:**

Mounted to body

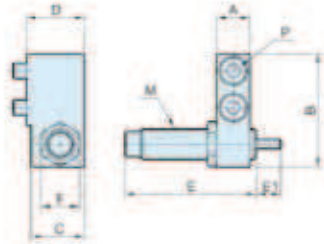

Mounted to table

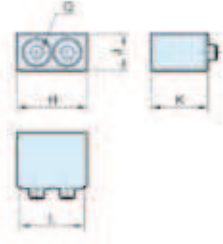

Bore mm	Order code	Mounted to body									Mounted to table				
		A	B	C	D	E	E1	F	M	P*	H	J	K	L	Q*
8	<b>P5SS-008-ES</b>	7	23	14	15,5	40,6	6	11	M8 x 1	M3 x 16	16,6	7	15,5	14,6	M3 x 16
12	<b>P5SS-012-ES</b>	9,5	31	14,5	16	40,6	6	11	M8 x 1	M4 x 16	20,5	10	15	18,5	M4 x 12
16	<b>P5SS-016-ES</b>	11	37	17,5	19	47	7	12,7	M10 x 1	M5 x 16	23	12	18,5	21	M5 x 16
20	<b>P5SS-020-ES</b>	13	45,5	23,5	26	67	12	19	M14 x 1.5	M6 x 25	27	13	25,5	25	M6 x 25
25	<b>P5SS-025-ES</b>	16	53,5	23,5	26,5	67	12	19	M14 x 1.5	M8 x 25	33	17	25,5	31	M8 x 25

\* Size of hexagon socket head cap screws

**Shock absorber at retraction end:**

Mounted to body

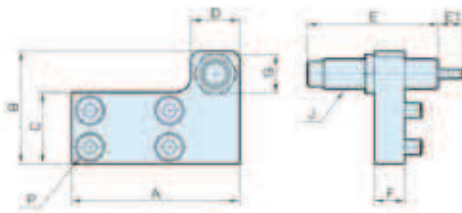

Mounted to table

P5SS-008

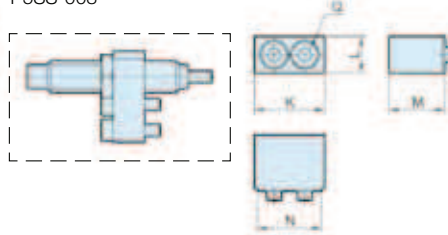

Bore mm	Order code	Mounted to body										Mounted to table				
		A	B	C	D	E	E1	F	G	J	P*	K	L	M	N	Q*
8	<b>P5SS-008-RS</b>	38	23	12,5	14	40,6	6	8	12	M8 x 1	M3 x 12	16,6	7	15,5	14,6	M3 x 16
12	<b>P5SS-012-RS</b>	45	31	18	14	40,6	6	8	11	M8 x 1	M4 x 8	20,5	10	15	18,5	M4 x 12
16	<b>P5SS-016-RS</b>	55	37	23,5	16	47	7	10	12,7	M10 x 1	M5 x 10	23	12	18,5	21	M5 x 16
20	<b>P5SS-020-RS</b>	70	47	29	23	67	12	12	19	M14 x 1.5	M5 x 12	27	13	25,5	25	M6 x 25
25	<b>P5SS-025-RS</b>	80	54	35	23	67	12	12	19	M14 x 1.5	M6 x 16	33	17	25,5	31	M8 x 25

\* Size of hexagon socket head cap screws